



Borough Based Jails Master Plan

Steering New York City toward a
smaller, safer and fairer justice system

BOROUGH-BASED JAILS MASTER PLAN

PROGRAM SUMMARY

CLOSE RIKERS ISLAND JAILS AS QUICKLY AS POSSIBLE

**REPLACE WITH A SMALLER, SAFER, FAIRER SYSTEM
THAT WILL HAVE:**

- Housing for a total of 5,000 people (requires 6,000 beds)
- Four borough-based sites (Manhattan, Brooklyn, Queens, and Bronx)
- Evidence-based programming to reduce recidivism
- Focus on reentry and community reengagement

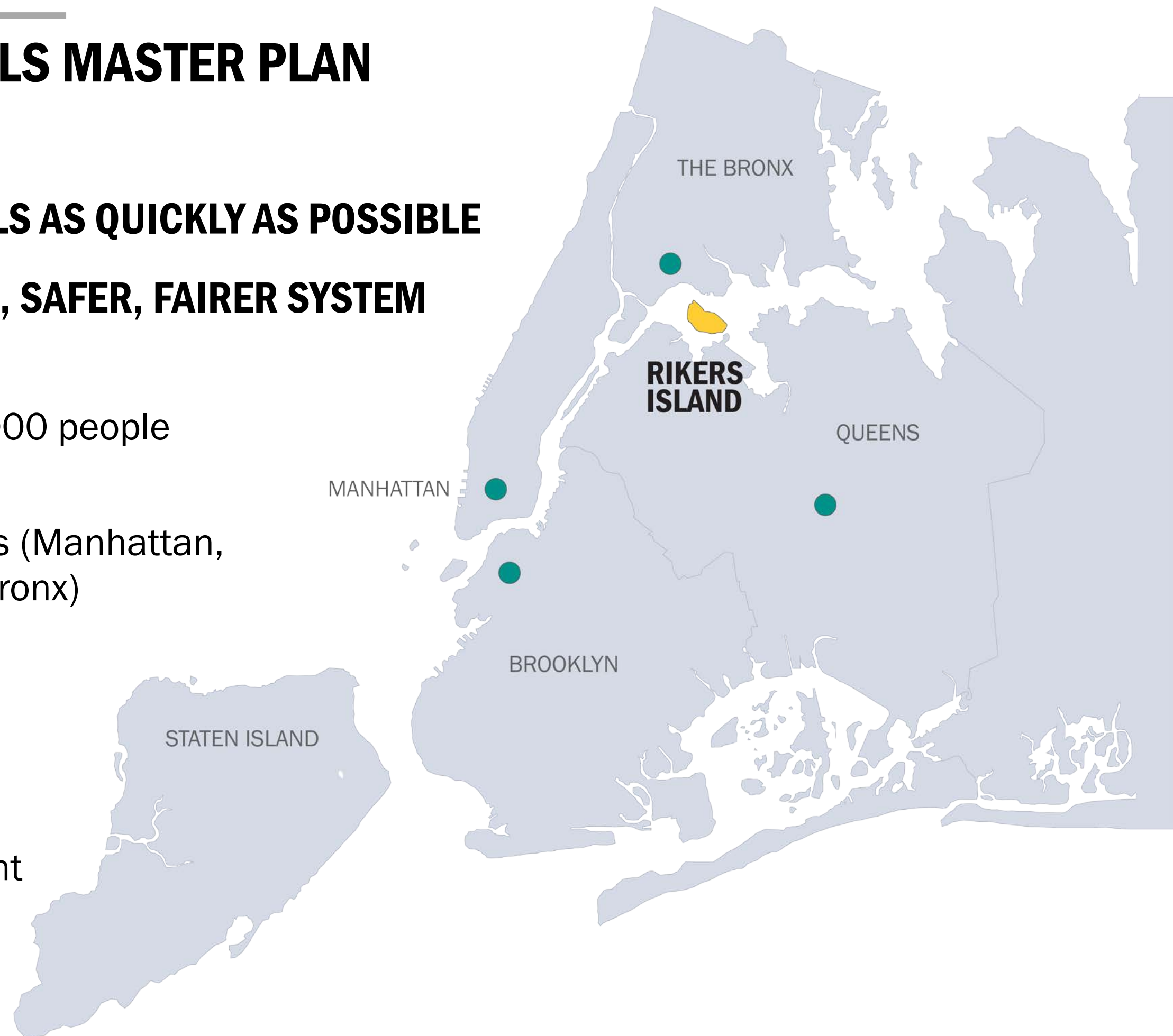

COORDINATED OUTREACH APPROACH

1

CITY-LED, BOROUGH-WIDE COMMUNITY ENGAGEMENT EFFORT

2

ADVOCATE, OTHER ELECTEDS, ALLIED-LED COMMUNITY MEETINGS

3

ULURP PROCESS

NEW YORK CITY'S DECREASING JAIL POPULATION

SMALLER POPULATION, SMALLER JAIL

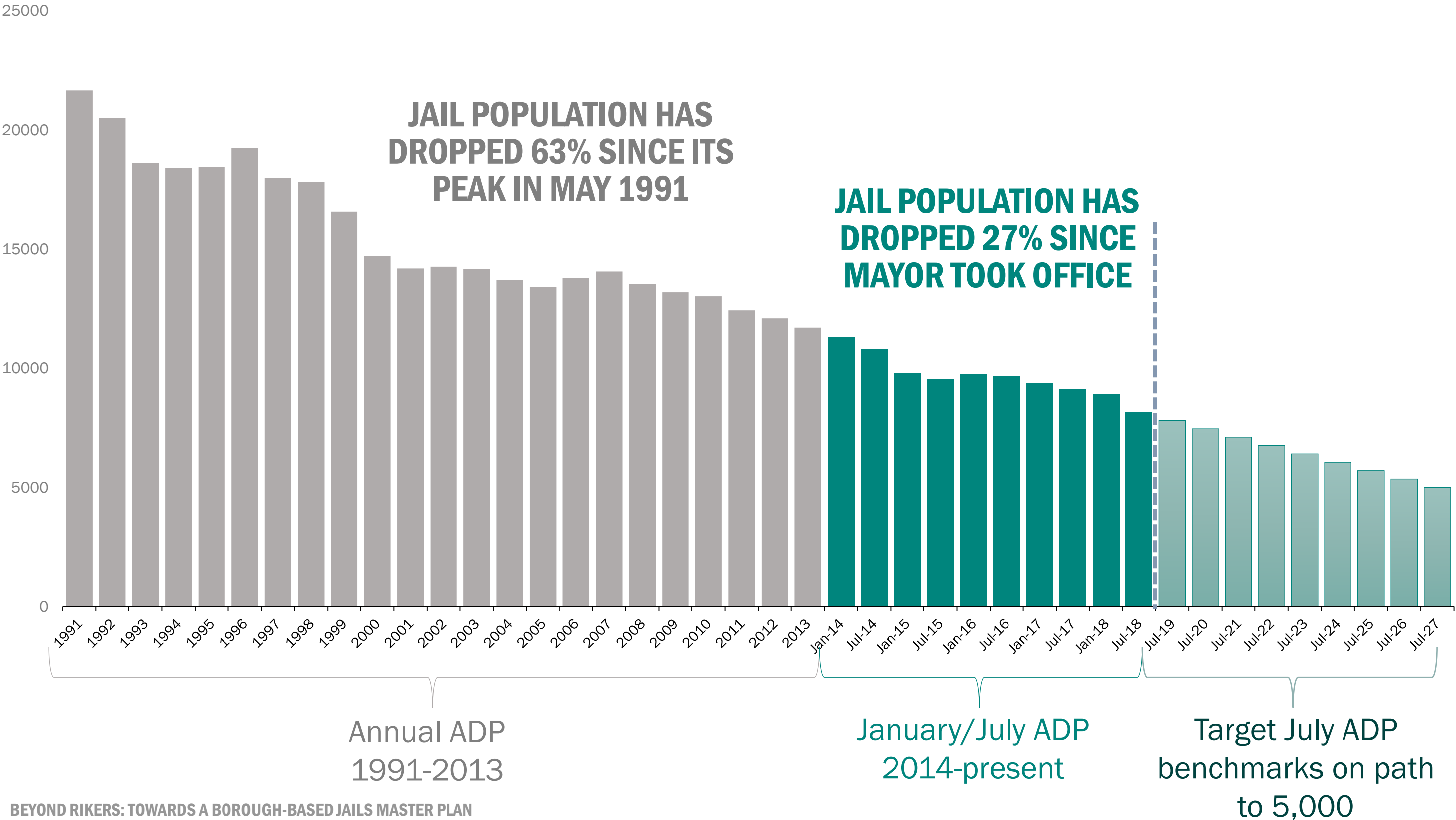



YEAR ONE UPDATE: CITY'S PROGRESS TOWARDS 5,000



REDUCING THE NUMBER OF PEOPLE IN JAIL

THE FOLLOWING INITIATIVES HAVE GREATLY REDUCED THE NUMBER OF PEOPLE IN JAIL

Initiatives	Jail Population Reduction
Diversion Initiatives (pretrial release)	Prevented over 9,000 people from entering jail pretrial
Alternatives to Jail Sentences	Resulted in 515 fewer people in jail (32% reduction in number of people serving a City sentence)
Bail Reform Initiatives (bail expeditors, expanding charitable bail fund, online bail)	Resulted in 520 fewer people in jail (60% reduction in people in jail on bail under \$2,000)
Targeted Initiatives: Women, Adolescents, Mental/Behavioral Health Issues	Jail population down 330, 136 and 832 people, respectively



YEAR ONE UPDATE: CITY'S PROGRESS TOWARDS 5,000

POPULATION CHANGES IN THE YEAR SINCE RELEASE OF CITY'S PLAN TO CLOSE RIKERS

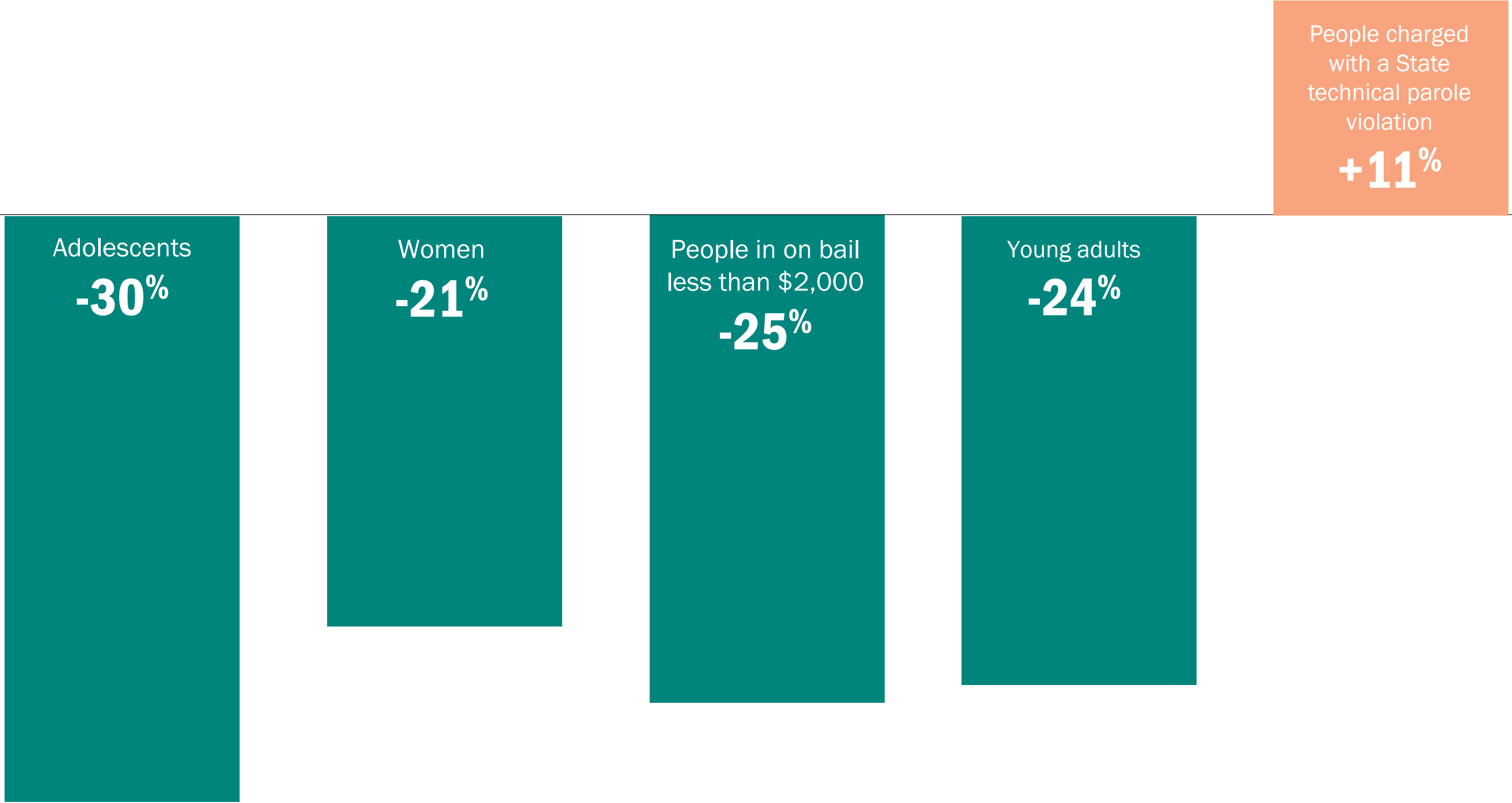

MONTHLY PROGRESS SINCE ANNOUNCING PLANS TO CLOSE RIKERS

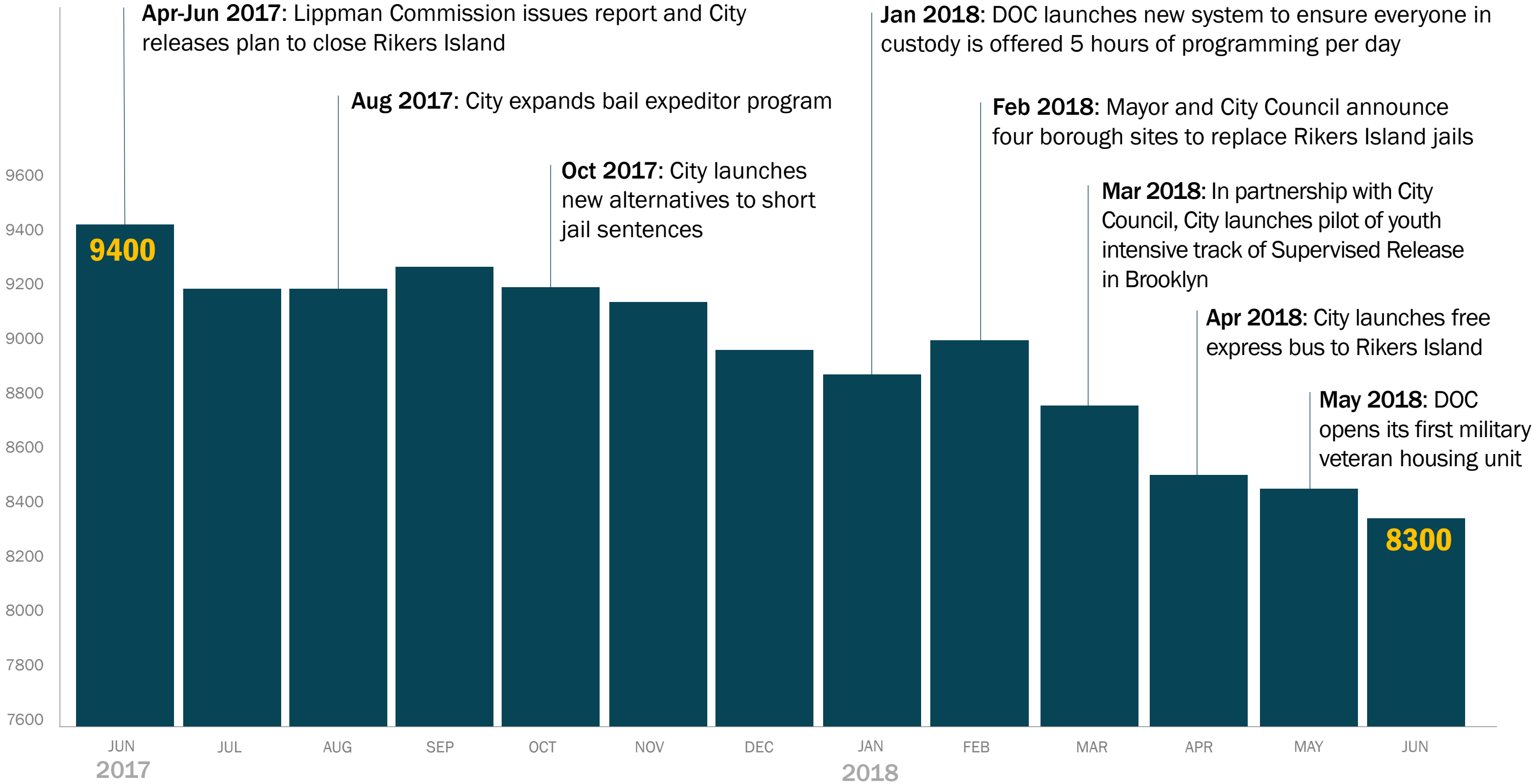

GOALS FOR NEW BOROUGH-BASED JAILS



Rehabilitative facilities designed to improve health, educational, and social outcomes
House people closer to their families and home communities
Provide greater access to social services and community service providers
Fewer families impacted by the criminal justice system



Close outdated and poorly designed jails on Rikers Island
Improve lines of sight and safety using a more modern layout
Reduce violence with new procedures, smaller units and better monitoring
Provide quality programming to reduce recidivism



Reduce unnecessary case delays which expand jail population and length of stay
Decrease housing and transportation costs through more efficient facilities and transportation routes as well as a smaller jail population
Streamline transfers between jail and courthouses
Improve attorney and service provider access to clients

PROCESS: HOW WE GOT HERE

INPUTS INTO VISION OF BOROUGH-BASED JAILS TO DATE

JUSTICE IMPLEMENTATION TASK FORCE

Design principles for the new facilities were developed by a team of experts, advocates and practitioners

Peer review from design experts (correctional, international and non-correctional experience)

REVIEW OF PAST REPORTS AND COMMUNITY ENGAGEMENT

on borough based jails, including the Justice Hubs proposal from the Lippman Commission

MEETINGS WITH ELECTED OFFICIALS,

local Councilmembers, DA's and Courts, Board of Correction, community organizations and focus groups with specific populations

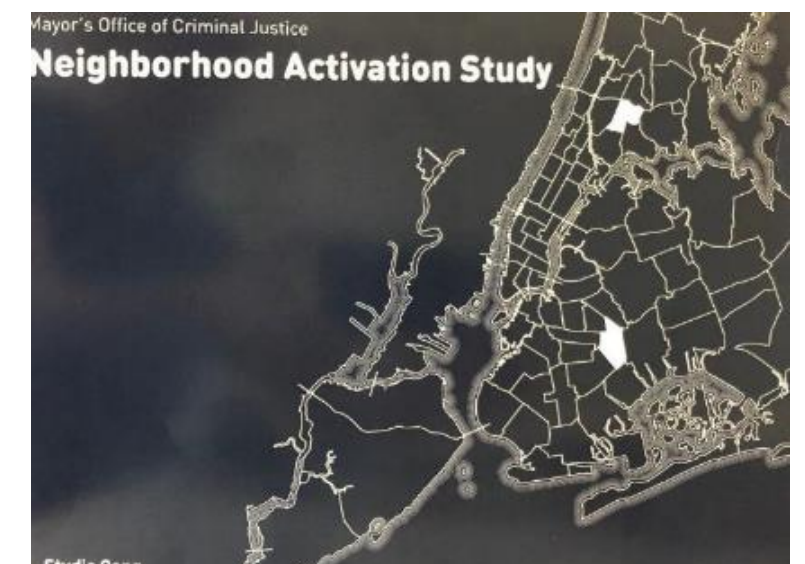
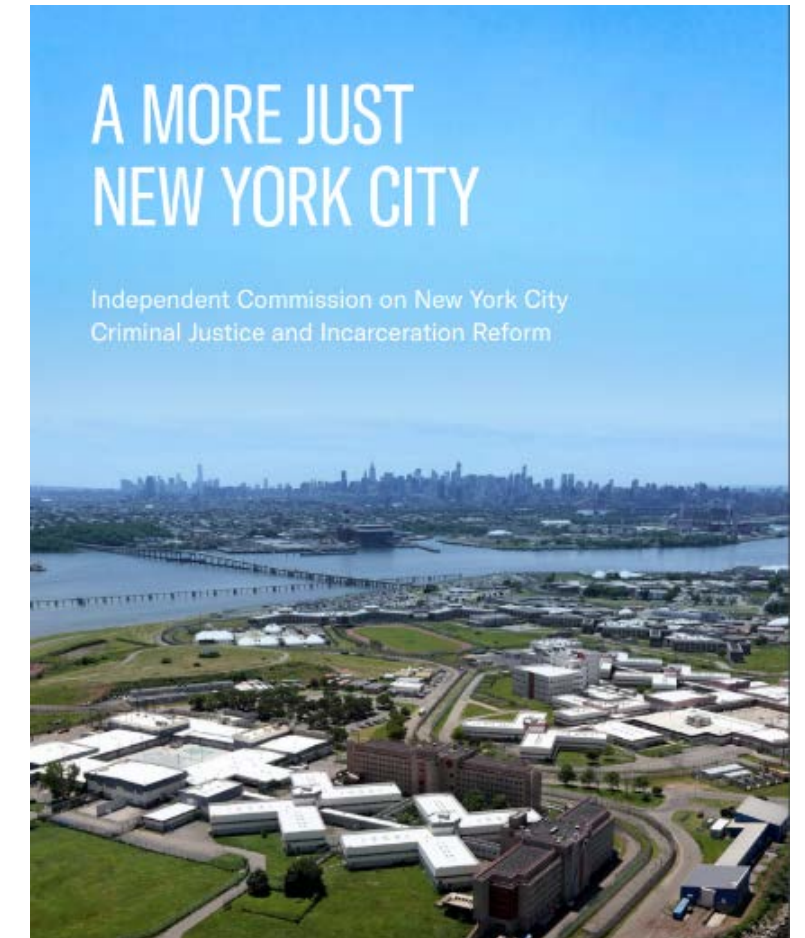



PROCESS: ENGAGING STAKEHOLDERS

INPUTS INTO VISION OF BOROUGH-BASED JAILS TO DATE











THE PROGRAM

IMPROVING THE INSIDE AND OUTSIDE EXPERIENCE

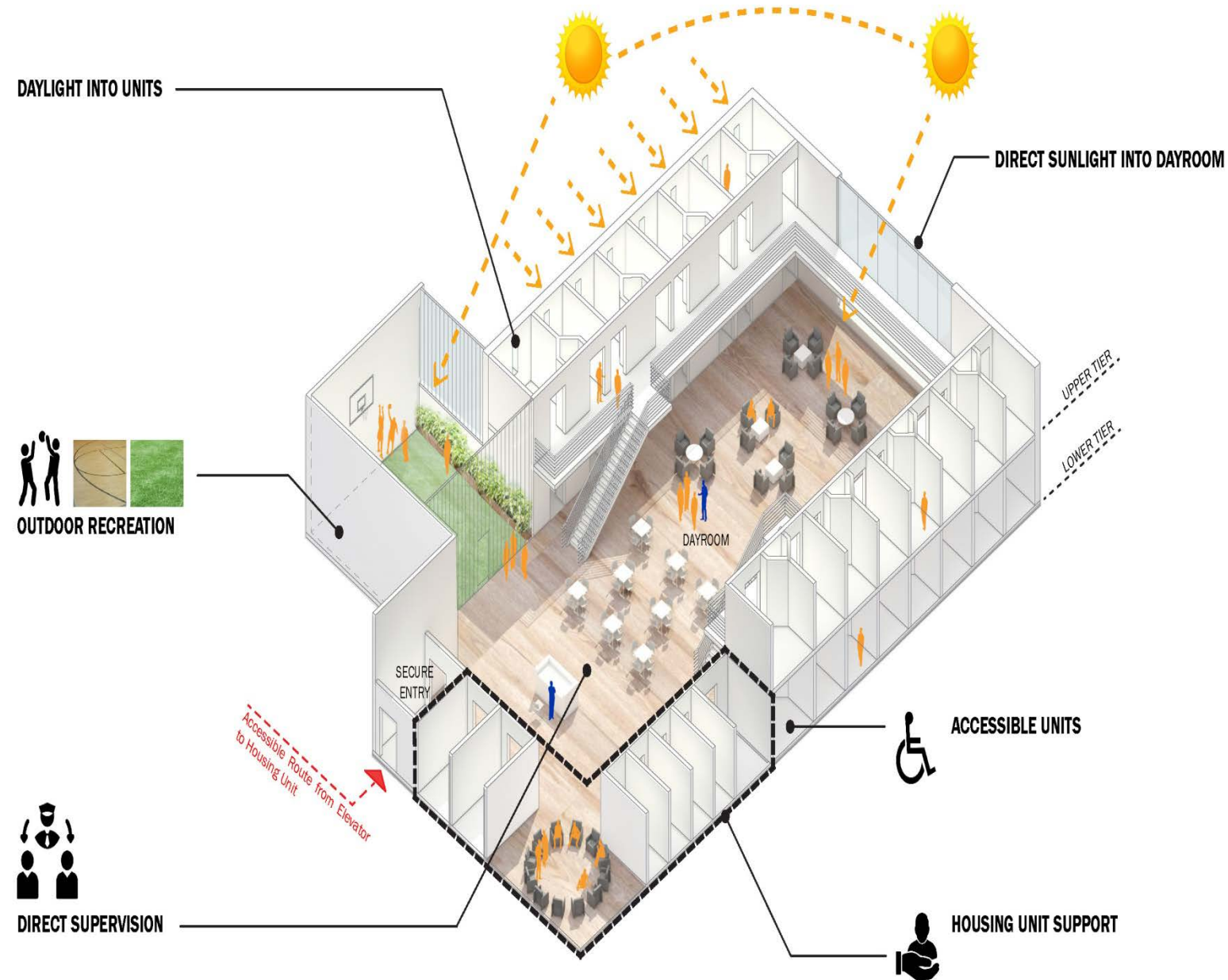

SAFE AND EFFICIENT FACILITY

- Smaller units to increase safety and maximize tailored programming opportunities



COMPLEMENT THE SURROUNDING NEIGHBORHOOD

- Leverage adjacent justice facilities
- Active street level frontages
- Civic presence on skyline

THE BORO-BASED JAIL PROGRAM: *BREAKING THE CYCLE OF VIOLENCE*

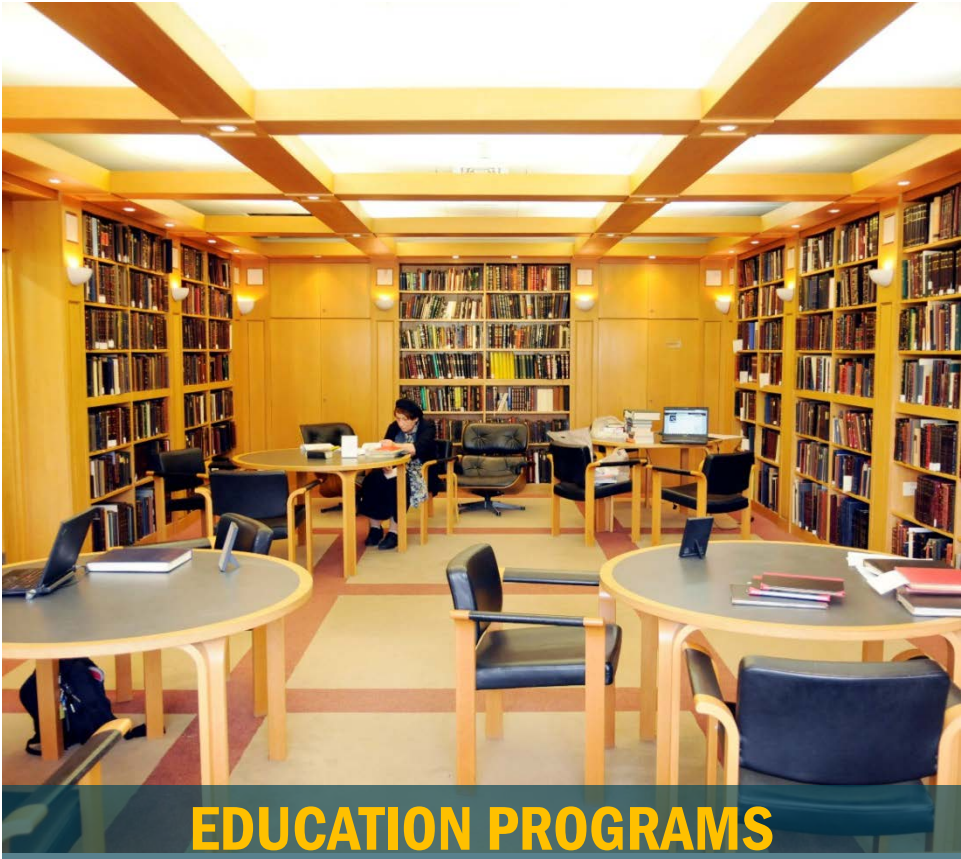

THE BORO-BASED JAILS PROGRAM: *BETTER OUTCOMES*

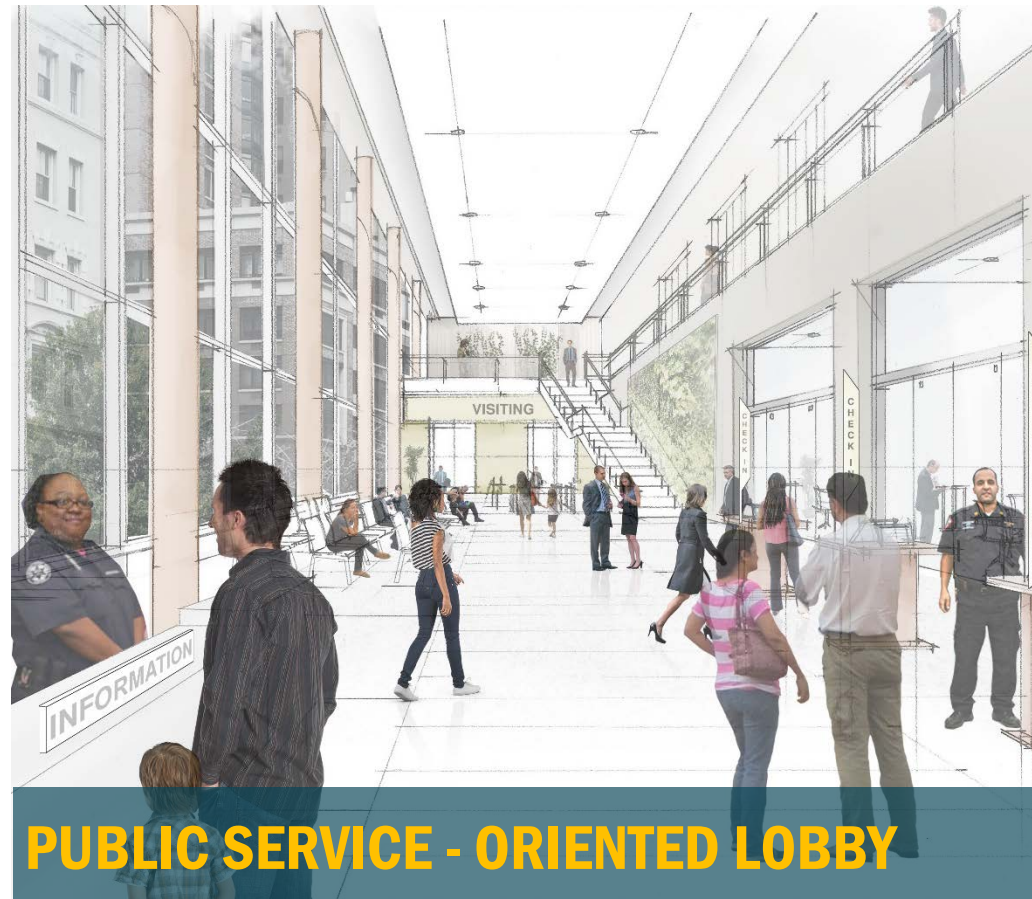



Van Cise-Simonet Detention Center, Denver, Colorado



LAS COLINAS DETENTION CENTER, SAN DIEGO

